

PARTS FOR PRESSURE BALANCE VALVES

SHIPPED PRIOR TO
MARCH 2000

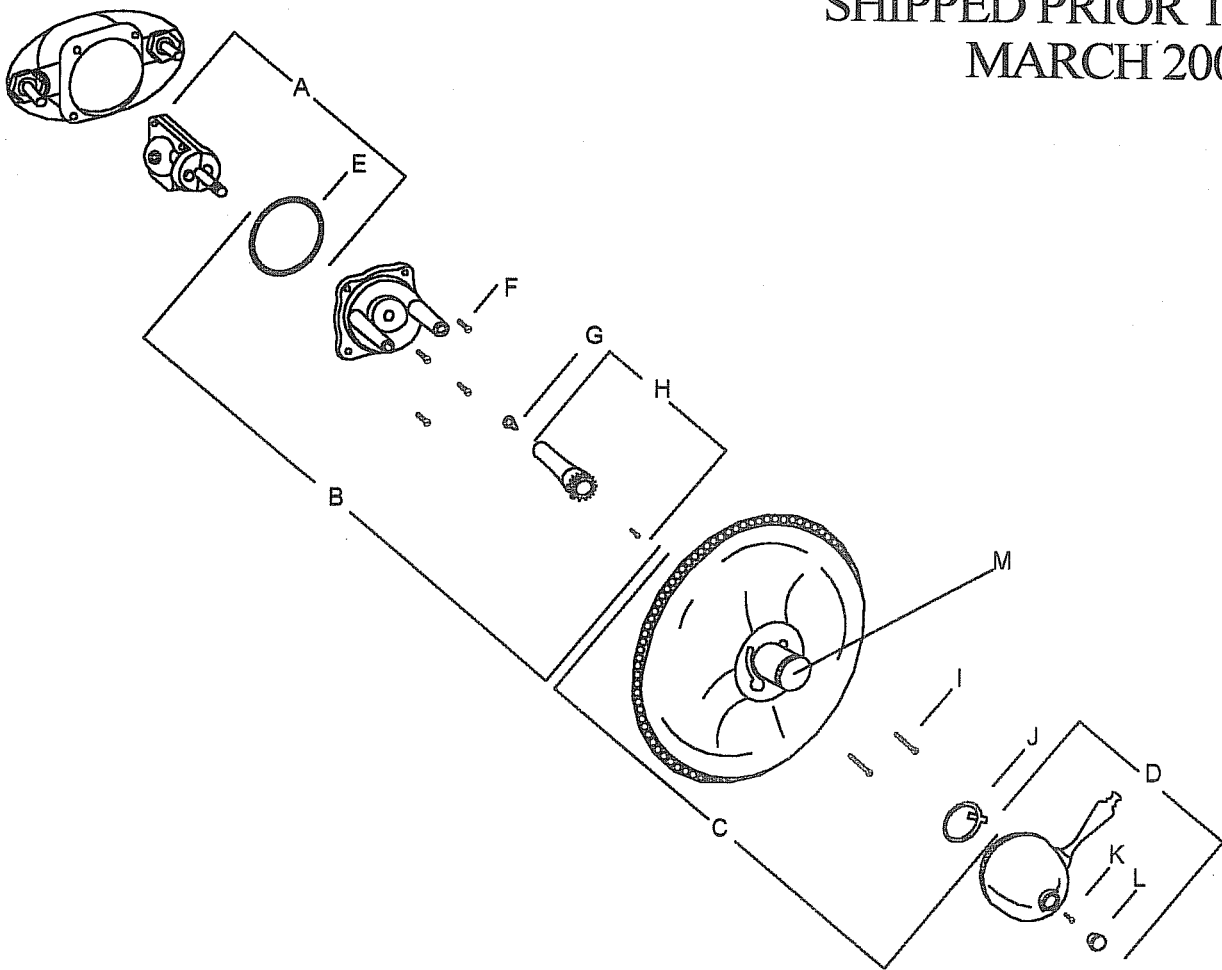

* 1/2" AND 3/4" EXTENSIONS ARE AVAILABLE.

| ITEM | PRODUCT # | DESCRIPTION | ITEM | PRODUCT # | DESCRIPTION |
|------|-----------------------------------|--|--------------|-----------------------------------|---|
| A | 062N 1285 | Replacement cartridge assembly (includes item E) | H | 062N 1232 | Replacement driver assembly |
| B | 062N 1216 | Complete valve body cover (includes items E, F, G, and H) | I | 681X 1371 | Face plate screw. 4 x 25mm (2 required) |
| C | Please see parts price list | Pressure balance face plate (includes items I, J, and M) | J | 062N 0372 | Hot temperature limit washer |
| D | Please see parts price list | Pressure balance handle (Includes items K and L) | K | 681X 2347 | Handle screw |
| E | 062N 0378 | "O" ring for valve cover | L | Please see parts price list | Cap for handle |
| F | 062N 0328 | Valve cover screw (4 required) | M | 062N 1253 | Escutcheon component kit |
| G | 062N 0395 | Valve cover stop | * | 062N 1207 | 1/2" Extension kit |
| | | | Not Shown | 062N 1208 | 3/4" Extension kit |
| | | | | 062N 50mm | 50mm Screw for stacking (1-1/4" Maximum extension) |